

# FORM B – BUILDING

Assessor's Number USGS Quad Area(s) Form Number

31B-188 Easthampton NTH.665

MASSACHUSETTS HISTORICAL COMMISSION  
MASSACHUSETTS ARCHIVES BUILDING  
220 MORRISSEY BOULEVARD  
BOSTON, MASSACHUSETTS 02125

**Town:** Northampton

**Place:** (neighborhood or village)

## Photograph



**Address:** 76 Gothic Street

**Historic Name:** Asahel A. Abell House

**Uses:** Present: Two-family residence

Original: Single-family house

**Date of Construction:** c. 1839

**Source:** Registry of Deeds

**Style/Form:** Greek Revival

**Architect/Builder:**

**Exterior Material:**

Foundation: brick

Wall/Trim: brick, vinyl, clapboards

Roof: asphalt

**Outbuildings/Secondary Structures:**

**Major Alterations** (with dates):

Rear two-story ell added with exterior stairs.

**Condition:** good

**Moved:** no | | yes | | **Date** \_\_\_\_\_

**Acreage:** 0.317 acres

**Setting:** This is an east-facing house on a corner lot bordered by a picket fence.

## Topographic or Assessor's Map

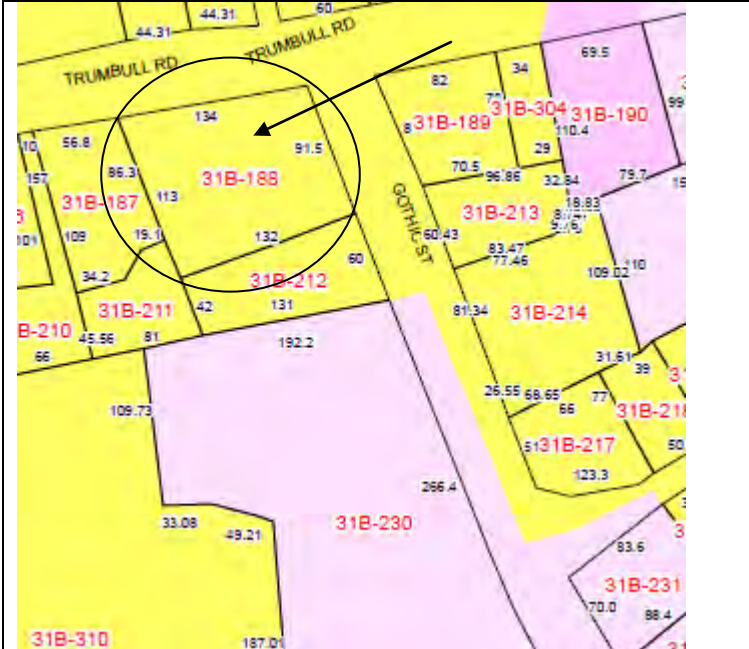

**Recorded by:** Bonnie Parsons

**Organization:** Pioneer Valley Planning Commission

**Date** (month / year): March, 2010

# INVENTORY FORM B CONTINUATION SHEET

[NORTHAMPTON ]

[76 GOTHIC STREET]

MASSACHUSETTS HISTORICAL COMMISSION

220 MORRISSEY BOULEVARD, BOSTON, MASSACHUSETTS 02125

Area(s) Form No.

NTH.665

\_\_\_ Recommended for listing in the National Register of Historic Places.

*If checked, you must attach a completed National Register Criteria Statement form.*

*Use as much space as necessary to complete the following entries, allowing text to flow onto additional continuation sheets.*

## ARCHITECTURAL DESCRIPTION:

*Describe architectural features. Evaluate the characteristics of this building in terms of other buildings within the community.*

This is an unusual Greek Revival style house with a two-story porch across its front-gabled façade. The brick house is two-and-a-half stories in height and the main block is three bays wide and the equivalent of four bays deep. It has paneled corner pilasters and its pediment rests on a two-story porch that has four paneled posts at both first and second story levels. Second story posts are connected by a square baluster railing. The pediment above the porch is vinyl-sided but in its field is a single, pointed window of Gothic design. The house has a center entry and first floor windows are elongated. The rear ells are clapboard-sided.

## HISTORICAL NARRATIVE

*Discuss the history of the building. Explain its associations with local (or state) history. Include uses of the building, and the role(s) the owners/occupants played within the community.*

From Form B of 1980: "In 1839, Asahel Abell, a local carpenter, purchased a half acre of land from the trustees of the Northampton Female Seminary. In the deed the land is described as that on which Mr. Abell 'recently erected a dwelling house.' Mr. Abell and his brother Ansell operated a combination saw and planing mill on lower Pleasant Street during the 1840's, but little else is known of their business practice. In 1842, Ansell sold the homestead on which both he and his brother were living, to his brother."

## BIBLIOGRAPHY and/or REFERENCES

Beers, F. W. County Atlas of Hampshire Massachusetts, New York, 1873.

Hales, John G. Plan of the Town or Northampton in the County of Hampshire, 1831.

Miller, D. L. Atlas of the City of Northampton and Town of Easthampton, Hampshire County, Massachusetts, Philadelphia, 1895.

Walker, George H. and Company. Atlas of Northampton City, Massachusetts, Boston, 1884.

Walling, Henry F. Map of Hampshire County, Massachusetts, New York, 1860.

Registry of Deeds: Bk. 227-P.81, 205-278, 170-459, 96-329, 84-13